

**F**

1. ALL KITCHENS TO HAVE TILE BACKSPLASH.
2. TUB TO HAVE CERAMIC TILE SURROUND ON MOISTURE RESISTANT BOARD.

COORDINATE KITCHEN MILLWORK  
W/ MILLWORK SUPPLIER SHOP  
DRAWINGS. ALL KITCHEN  
MILLWORK TO INCLUDE A BANK  
OF DRAWERS, AND 24" BUILT  
OUT CABINETS OVER FRIDGE.

GRAB BAR BLOCKING IS TO BE  
INSTALLED AS REQUIRED BY CODE  
TO THE APPROPRIATE LOCATIONS

ROOM	ROOM AREA	GLAZING AREA	PERCENTAGE
LIVING/ DINING ROOM	140 sq. ft.	39.03 sq. ft.	28%
BEDROOM 1	102 sq. ft.	25.00 sq. ft.	25%

TYPICAL NOTE (SEE DETAILS):  
STUD WALL REINFORCEMENT.

(1) IF NO WALL STUDS OR SHEET STEEL WALL STUDS ENCLOSE THE MAIN BATHROOM IN A DWELLING UNIT, REINFORCEMENT SHALL BE INSTALLED TO PERMIT THE FUTURE INSTALLATION OF THE FOLLOWING:

- (a) FOR A WATER CLOSET, A GRAB BAR DESCRIBED IN CLAUSES 3.8.3.8.(3)(A) AND A GRAB BAR DESCRIBED IN CLAUSE 3.8.3.8.(3)(C).
- (b) FOR A SHOWER, A GRAB BAR DESCRIBED IN CLAUSE 3.8.3.13.(2)(F), AND
- (c) FOR A BATHTUB, A GRAB BAR DESCRIBED IN CLAUSE 3.8.3.13.(4)(C).

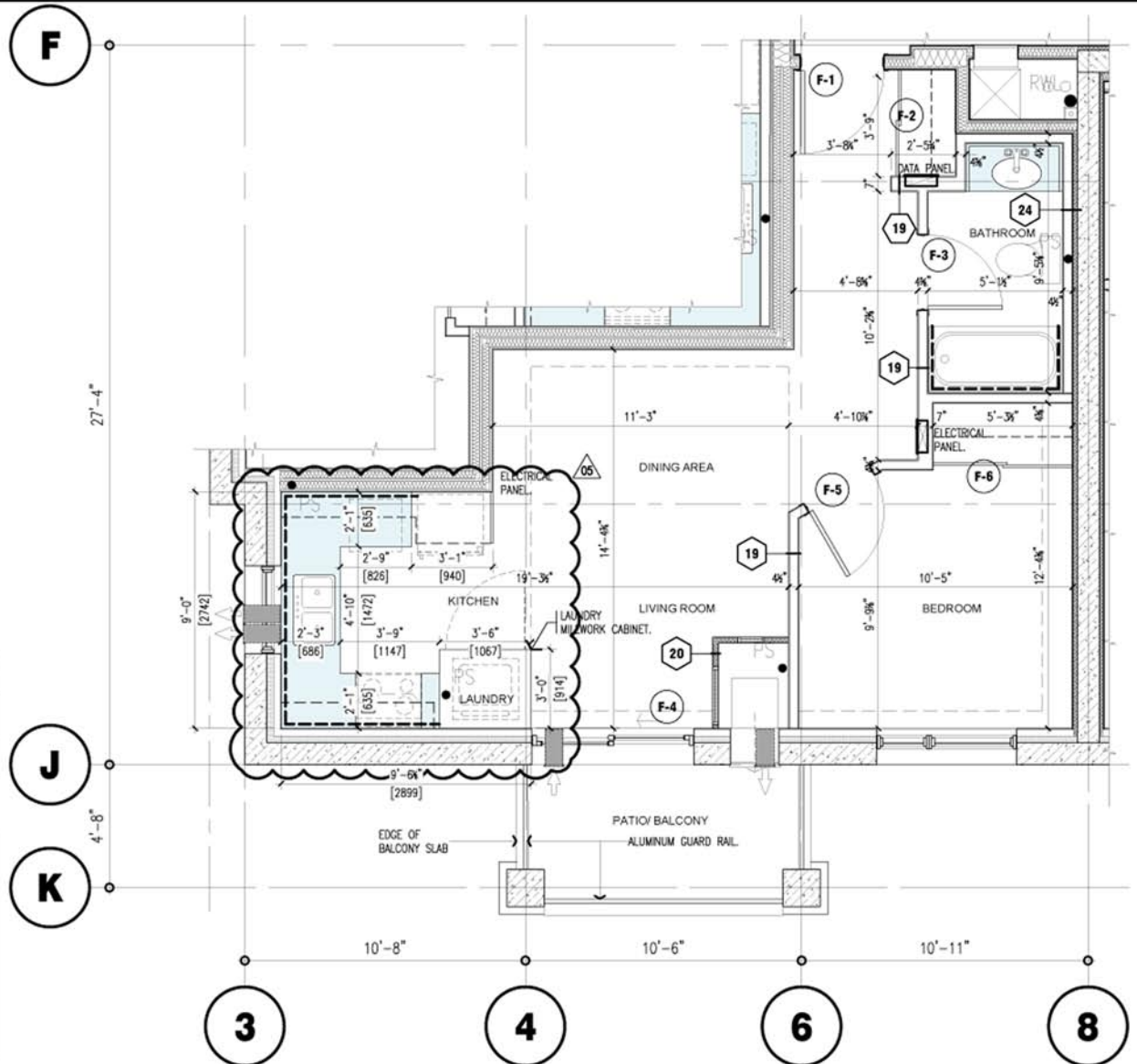

7

## SUITE 'F' PLAN

scale:  $1/4^\circ = 1' - 0''$