

1. ALL KITCHENS TO HAVE TILE BACKSPLASH.
2. TUB TO HAVE CERAMIC TILE SURROUND ON MOISTURE RESISTANT BOARD.

COORDINATE KITCHEN MILLWORK
W/ MILLWORK SUPPLIER SHOP
DRAWINGS. ALL KITCHEN
MILLWORK TO INCLUDE A BANK
OF DRAWERS, AND 24" BUILT
OUT CABINETS OVER FRIDGE.

GRAB BAR BLOCKING IS TO BE
INSTALLED AS REQUIRED BY CODE
TO THE APPROPRIATE LOCATIONS

ROOM	ROOM AREA	GLAZING AREA	PERCENTAGE
LIVING/ DINING ROOM	140 sq. ft.	39.03 sq. ft.	23%
BEDROOM 1	107sq. ft.	14.6 sq. ft. x 2	27%

TYPICAL NOTE (SEE DETAILS):

STUD WALL REINFORCEMENT

(1) IF WOOD WALL STUDS OR SHEET STEEL WALL STUDS ENCLOSE THE MAIN BATHROOM IN A DWELLING UNIT, REINFORCEMENT SHALL BE INSTALLED TO PERMIT THE FUTURE INSTALLATION OF THE FOLLOWING:

(a) FOR A WATER CLOSET, A GRAB BAR DESCRIBED IN CLAUSES 3.8.3.8(3)(A) AND A GRAB BAR DESCRIBED IN CLAUSE 3.8.3.8(3)(C).

(b) FOR A SHOWER, A GRAB BAR DESCRIBED IN CLAUSE 3.8.3.13.(2)(F), AND

(c) FOR A BATHTUB, A GRAB BAR DESCRIBED IN CLAUSE 3.8.3.13.(4)(C).

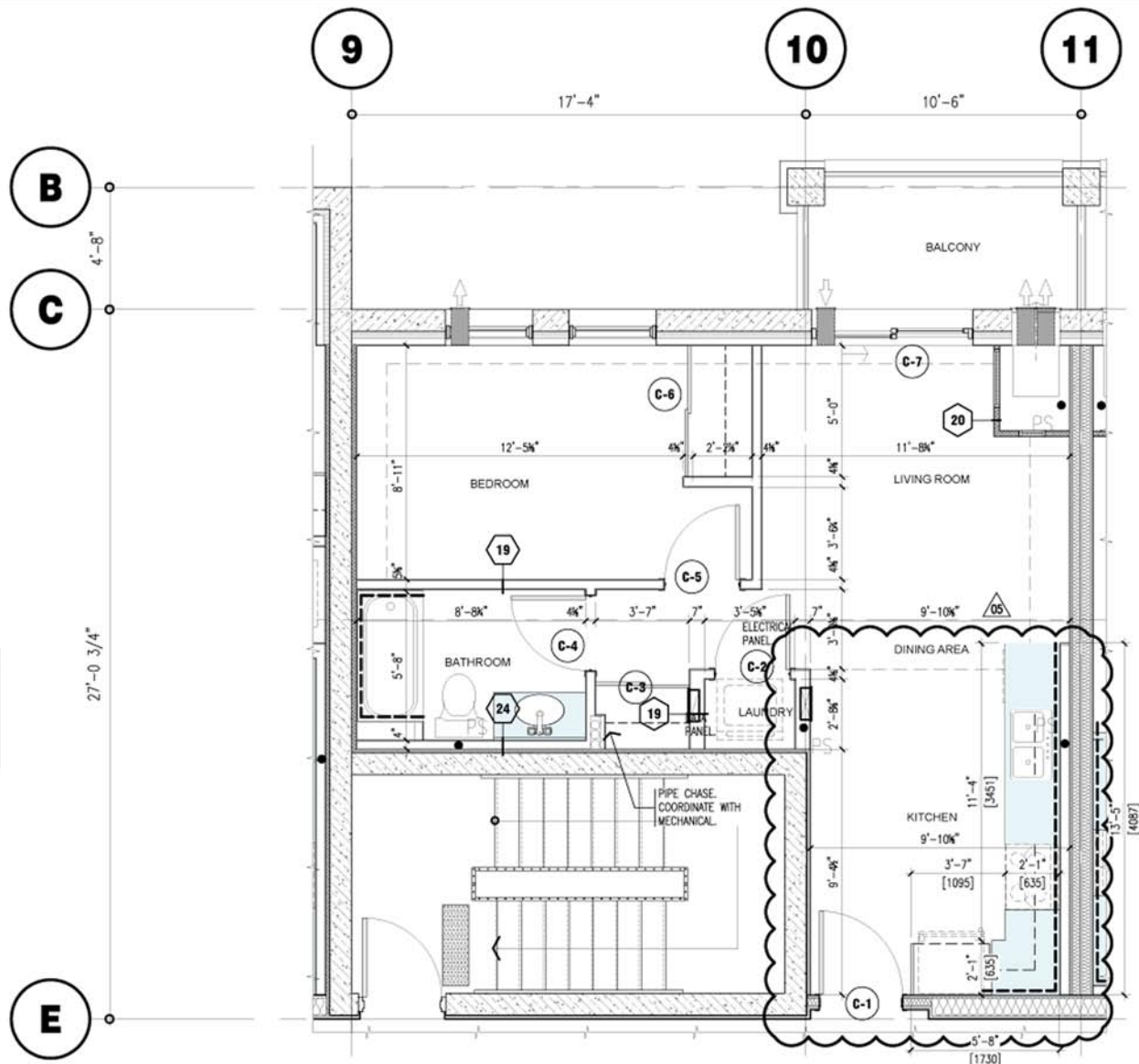

3

SUITE 'C' PLAN

scale: $1/4" = 1'-0"$